

Luminaires d'ambiance secours

Projets éclairage de secours

Schéma de principe

AUTONOME

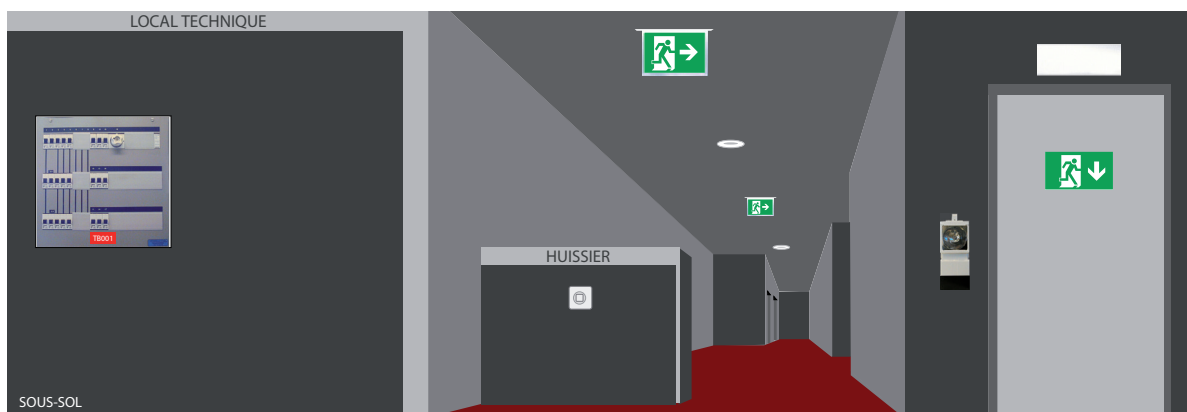
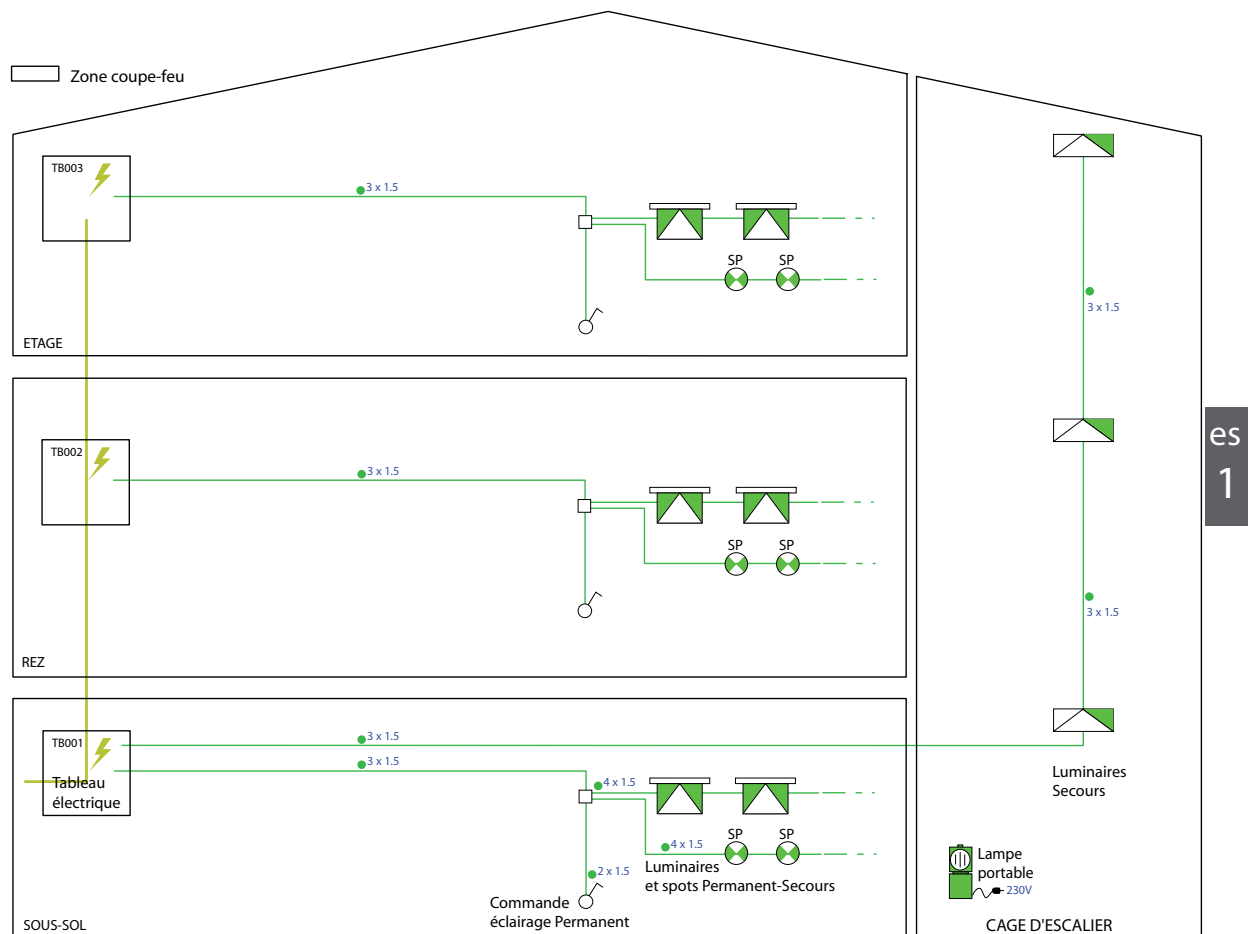

- |                                    |                  |
|------------------------------------|------------------|
| Câble TT 1.5 <sup>m</sup>          | Câble U72        |
| Câble TT 1.5 <sup>m</sup> anti-feu | Câble U72 blindé |
| Câble TT 2.5 <sup>m</sup>          | Câble G51        |